

SAN FRANCISCO

PROPER

HOTEL

GILDA'S PRIVATE DINING ROOM
FLOORPLAN AND SPACE CAPACITY
228 Sq. Ft.

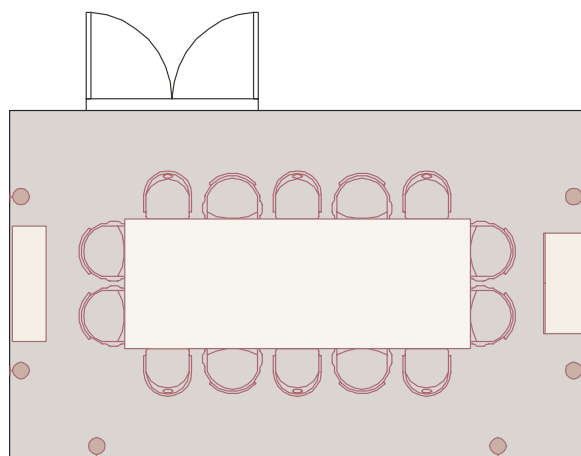

HIGHLIGHTS

- ◆ Ideal for intimate family milestones, corporate and charity luncheons, preview and launch dinners, wine dinners, and cocktail gatherings
- ◆ Seating capacity of 14 guests
- ◆ Fully customized food and beverage menus by award-winning culinary team
- ◆ Fully customized cocktail menus by BVHospitality
- ◆ Serviced by the professional staff from Villon, the lobby restaurant
- ◆ ADA-accessible

1100 MARKET STREET, SAN FRANCISCO, CA 94102 ▪ SFSALES@PROPERHOTEL.COM ▪ 628.895.2032

PROPERHOTEL.COM

SAN FRANCISCO

PROPER

HOTEL

CONFERENCE ROOM: RUDIUM HALL I

FLOORPLAN AND SPACE CAPACITY

880 Sq. Ft.

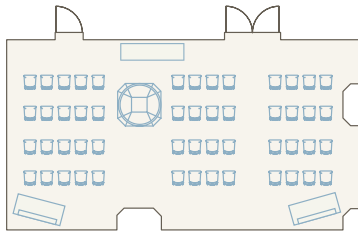

THEATER

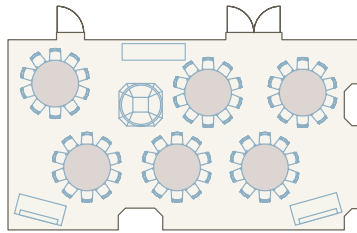

ROUNDS

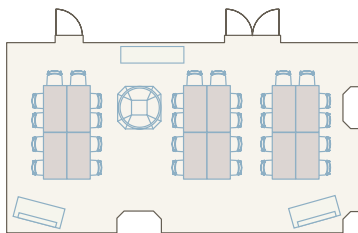

CONFERENCE

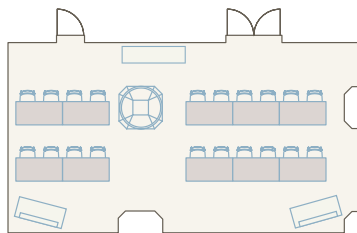

CLASSROOM

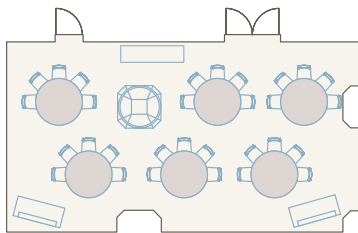

CRESCENT ROUNDS

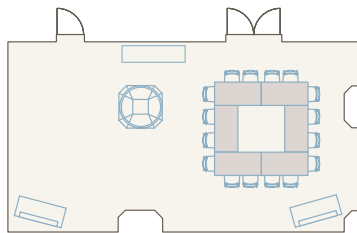

HOLLOW SQUARE

SETUP

CAPACITY

RECEPTION

75

THEATER

52

ROUNDS

60

CONFERENCE

30

CLASSROOM

20

CRESCENT ROUNDS

30

HOLLOW SQUARE

16

U-SHAPE

14

SAN FRANCISCO

PROPER

HOTEL

BOARDROOM: RUDIUM HALL II
FLOORPLAN AND SPACE CAPACITY
280 Sq. Ft.

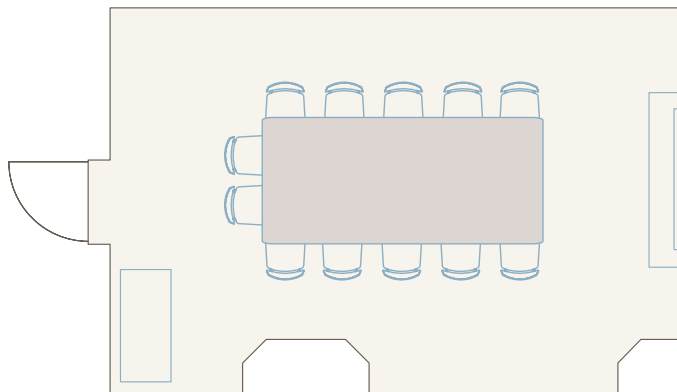

HIGHLIGHTS

- ◆ Ideal for board meetings, executive breakfasts, think sessions, partner luncheons, and breakout sessions
- ◆ Seated capacity of up to 12
- ◆ Mounted Samsung Smart TV with flexible A/V options and streaming capabilities
- ◆ ADA-accessible

1100 MARKET STREET, SAN FRANCISCO, CA 94102 ▪ SFSALES@PROPERHOTEL.COM ▪ 628.895.2032

PROPERHOTEL.COM

SAN FRANCISCO

PROPER

HOTEL

CHARMAINE'S ROOFTOP BAR & LOUNGE
 FLOORPLAN AND SPACE CAPACITY
 Indoor 1,120 Sq. Ft. | Outdoor 1,200 Sq. Ft.

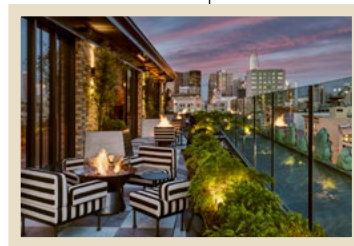
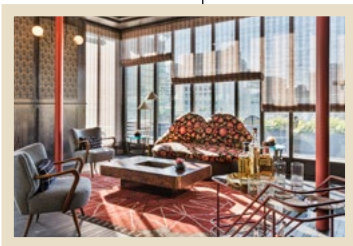
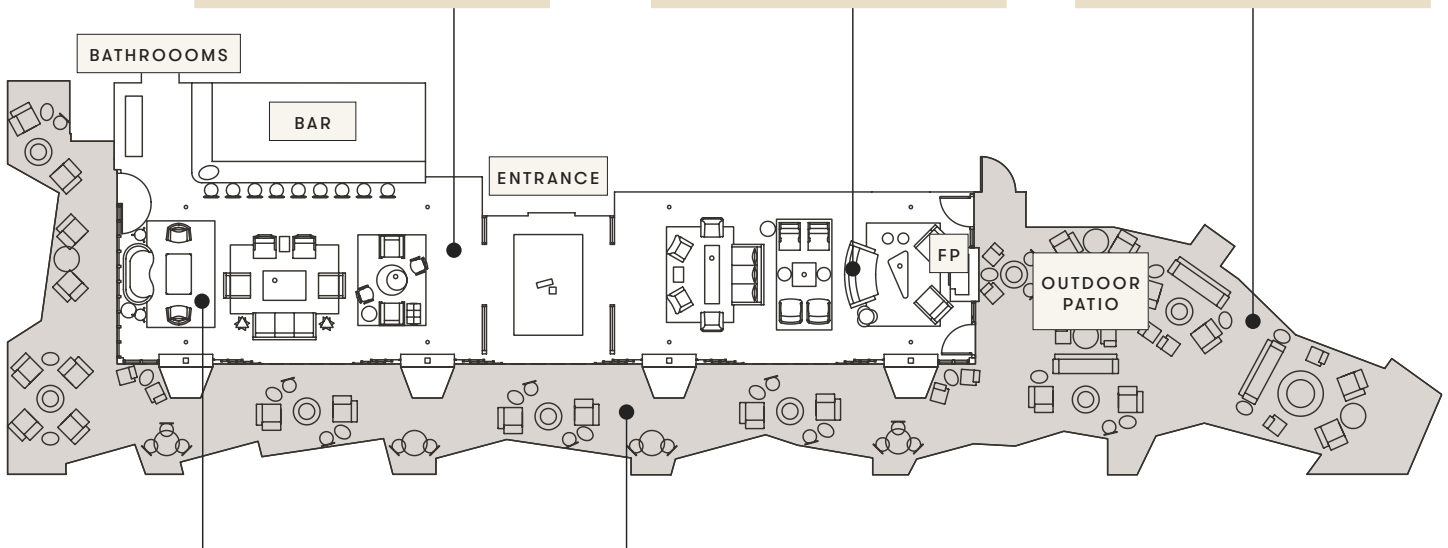
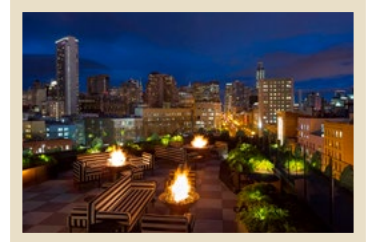

HIGHLIGHTS

- ◆ Ideal for conference kick-offs, fundraisers, fashion previews, release parties, post-parties, cocktail parties, engagement parties and more
- ◆ Accordion glass doors for a true indoor/outdoor experience.
- ◆ Fireplace & Fire Pits
- ◆ Broad, sweeping city and bay views
- ◆ Partial and full buyouts available
- ◆ Fully customized menus and cocktails by award-winning culinary team and BVHospitality
- ◆ Direct elevator access
- ◆ Valet Parking
- ◆ ADA-accessible

CAPACITY

SPACE

RECEPTION

FULL ROOFTOP

101-200 (STANDING)

PARTIAL ROOFTOP

25-100 (STANDING)

1100 MARKET STREET, SAN FRANCISCO, CA 94102 ▪ SFSALES@PROPERHOTEL.COM ▪ 628.895.2032

PROPERHOTEL.COM